

HARDWARE & ACCESSORIES



Hardware

- Hardware accessories p. 268
- Fasteners p. 272

Accessories

- Earthing systems p. 273
- Other accessories p. 274



HARDWARE

TRCC + HE PANHEAD BOLTS

	p	Description	Code	Weight kg/100
EZ	100	TRCC M6x12 HE EZ	648001	0.800
	100	TRCC M6x15 HE EZ	648002	0.900
	100	TRCC M6x20 HE EZ	648003	0.900
	100	TRCC M6x30 HE EZ	648132	1.100
	100	TRCC M8x18 HE EZ	648004	1.400
	100	TRCC M8x40 HE EZ	648109	2.800
	100	TRCC M10x25 HE EZ	648010	3.000

	p	Description	Code	Weight kg/100
GM	100	TRCC M6x12 HE GM	651001	0.800
	100	TRCC M6x15 HE GM	651002	0.900
	100	TRCC M6x20 HE GM	651003	0.900
	100	TRCC M6x30 HE GM	651132	1.100
	100	TRCC M8x18 HE GM	651004	1.400
	100	TRCC M10x25 HE GM	651010	3.000

	p	Description	Code	Weight kg/100
SS316	100	TRCC M6x12 HE SS316/A4	529001	0.800
	100	TRCC M6x15 HE SS316/A4	529002	0.900
	100	TRCC M6x20 HE SS316/A4	529003	0.900
	100	TRCC M8x18 HE SS316/A4	529004	1.400

	p	Description	Code	Weight kg/100
AL	100	TRCC M6x15 HE AL	650002	0.002



Round-head square-neck bolt (class 4.8)

TRL + HE PANHEAD BOLTS

	p	Description	Code	Weight kg/100
EZ	100	TRL M6x12 HE EZ	520617	0.900
	100	TRL M6x15 HE EZ	648147	0.900
	100	TRL M6x20 HE EZ	648619	1.000
	100	TRL M6x30 HE EZ	648005	1.100
	100	TRL M6x40 HE EZ	648152	1.200
	100	TRL M6x50 HE EZ	648153	1.400

	p	Description	Code	Weight kg/100
SS316	100	TRL M6x12 HE SS316/A4	320617	0.900
	100	TRL M6x15 HE SS316/A4	529147	0.900
	100	TRL M6x20 HE SS316/A4	529107	1.000
	100	TRL M6x30 HE SS316/A4	529108	1.100



Slotted round-head bolt and HE nut (class 4.8)

TRL SCREWS



	p	Description	Code	Weight kg/100
EZ	100	SCREW TRL M6x12 EZ	023371	0.500





HARDWARE



TH + HE BOLTS

		Description	Code	Weight kg/100
EZ	100	TH M 8x15 HE EZ	648007	1.700
		Description	Code	Weight kg/100
GM	100	TH M 8x15 HE GM	651007	1.700

Hexagonal head bolts and serrated flange nut (class 4.8)



TH HEXAGONAL HEAD SCREWS

		Description	Code	Weight kg/100
EZ	100	SCREW TH M6x20 EZ	648045	0.500
	100	SCREW TH M8x15 EZ	648018	1.100
	100	SCREW TH M8x20 EZ	648120	1.200
	100	SCREW TH M8x25 EZ	648101	1.300
	100	SCREW TH M10x20 EZ	648046	2.300
	100	SCREW TH M10x25 EZ	648048	2.500
	100	SCREW TH M10x30 EZ	648028	2.800
	100	SCREW TH M10x50 EZ	648071	3.800
	100	SCREW TH M10x60 EZ	502298	4.300
	100	SCREW TH M12x25 EZ	648021	3.600
	100	SCREW TH M12x35 EZ	648150	4.300
	100	SCREW TH M12x50 EZ	648047	5.400
		Description	Code	Weight kg/100
GM	100	SCREW TH M8x20 GM	651120	1.200
	100	SCREW TH M10x25 GM	651144	2.500
	100	SCREW TH M10x30 GM	651028	3.300
	100	SCREW TH M12x25 GM	651021	3.600
	100	SCREW TH M12x35 GM	651150	4.300
		Description	Code	Weight kg/100
SS316	100	SCREW TH M8x15 SS316/A4	529018	1.100
	100	SCREW TH M8x20 SS316/A4	529120	1.200
	100	SCREW TH M8x50 SS316/A4	221492	2.100
	100	SCREW TH M12x25 SS316/A4	529021	3.600





FLANGE NUTS & HEXAGONAL HEAD SCREWS



		Description	Code	Weight kg/100
EZ	100	SCREW THE M8x20 EZ	648203	1.200
	100	SCREW THE M8x50 EZ	648204	2.400



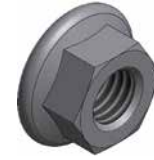

HARDWARE
HE NUTS

	 p	Description	Code	Weight kg/100
EZ	100	HE M6 EZ	648064	0.600
	100	HE M8 EZ	648065	0.600
	100	HE M10 EZ	648081	1.100
	100	HE M12 EZ	648139	1.900
	 p	Description	Code	Weight kg/100
SS316	100	HE M6 SS316/A4	529064	0.600
	100	HE M8 SS316/A4	529065	0.600

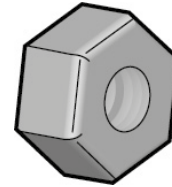

HU NUTS

	 p	Description	Code	Weight kg/100
EZ	100	HU M8 EZ	023251	0.500
	 p	Description	Code	Weight kg/100
SS316	100	HU M10 SS316A4	529058	1.200
	100	HU M12 SS316/A4	529022	1.500

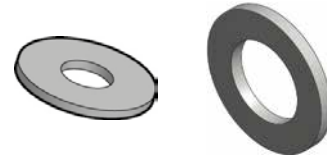

L AND LL WASHERS

	 p	Description	Code	Weight kg/100
EZ	100	L Ø6 EZ	648024	0.500
	100	L Ø8 EZ	648020	0.700
	100	L Ø10 EZ	648034	1.200
	100	L Ø12 EZ	648023	1.700
	100	LL Ø6 EZ	648200	0.400
	100	LL Ø8 EZ	648201	0.400

TOOTHED CONTACT WASHERS

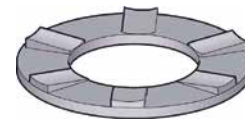
	 p	Description	Code	Weight kg/100
EZ	100	TOOTHED CONTACT WASHER M6 G	040051	0.100

AZ SERRATED WASHERS

	 p	Description	Code	Weight kg/100
EZ	100	AZ Ø6 EZ	648029	0.100
	100	AZ Ø8 EZ	648033	0.100
	100	AZ Ø10 EZ	648030	0.100
	100	AZ Ø12 EZ	648014	0.200



HARDWARE
STRUT 41 SPRING NUTS

	p	Description	Code	Weight kg/100
EZ	100	SPRING NUT M6 STRUT EZ	648025	2.900
	100	SPRING NUT M8 STRUT EZ	648031	2.800
	100	SPRING NUT M10 STRUT EZ	648027	3.500
	100	SPRING NUT M12 STRUT EZ	648013	3.800

STRUT 41 NUTS

	p	Description	Code	Weight kg/100
EZ	100	NUT M6 STRUT EZ	648035	2.900
	100	NUT M8 STRUT EZ	648037	2.300
	100	NUT M10 STRUT EZ	648038	3.300
	100	NUT M12 STRUT EZ	648039	3.600

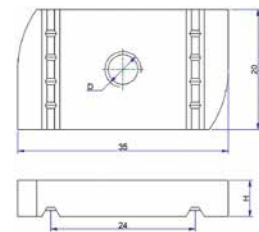
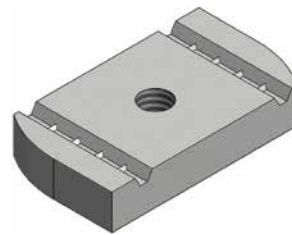

	p	Description	Code	Weight kg/100
GM	100	NUT M6 STRUT GM	651035	2.700
	100	NUT M8 STRUT GM	651037	3.100
	100	NUT M10 STRUT GM	651038	3.400
	100	NUT M12 STRUT GM	651039	3.400

TF THREADED RODS

	p	Description	Code	Weight kg/p
EZ	10	TF M6 1M EZ	023100	0.170
	10	TF M8 1M EZ	023101	0.310
	10	TF M10 1M EZ	023102	0.500
	10	TF M12 1M EZ	023103	0.700

	p	Description	Code	Weight kg/p
SS304	10	TR M6 1M SS304/A2	223200	0.180
	10	TF M8 1M SS304/A2	223151	0.310
	10	TF M10 1M SS304/A2	040100	0.500
	10	TR M12 1M SS304/A2	223253	0.700

ROD COUPLERS

	p	Description	Code	Weight kg/100
EZ	100	M12 EZ	023203	7.200
	100	M10 EZ	023202	4.200
	100	M8 EZ	023201	1.800
	100	M6 EZ	023200	1.400

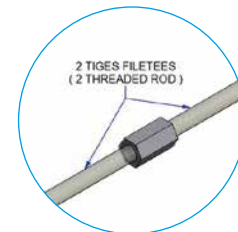
SPLIT PINS

	p	Description	Code	Weight kg/100
EZ	100	V7x80 EZ	023050	2.300
	100	V8x90 EZ	023051	3.500
SS304	1	V8x90 304A2	223051	0.035





CLAMPS

HSK BEAM CLAMPS

p	Description	Code	Weight kg/p	Th. mm
HDG	50 HSK.10 HDG	195800	0.150	7
	50 HSK.15 HDG	195909	0.180	7
	50 HSK.20 HDG	196104	0.200	7
	50 HSK.25 HDG	196203	0.240	7
	50 HSK.30 HDG	196005	0.300	7
	50 HSK.35 HDG	196302	0.360	7
	50 HSK.40 HDG	196401	0.440	7

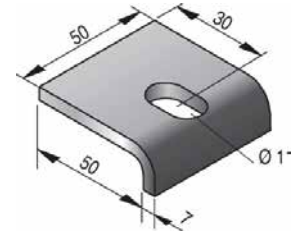

Recommended for heavy duty loads on metal beams with **STRUT 41** or **UPN channels**

HSKS BEAM CLAMPS

p	Description	Code	Weight kg/p	Th. mm
HDG	25 HSKS.10 HDG	196425	0.210	8
	25 HSKS.15 HDG	196432	0.250	8
	25 HSKS.20 HDG	196449	0.270	8
	25 HSKS.25 HDG	196456	0.330	8
	25 HSKS.30 HDG	196463	0.410	8
	25 HSKS.35 HDG	196470	0.490	8
	25 HSKS.40 HDG	196487	0.600	8

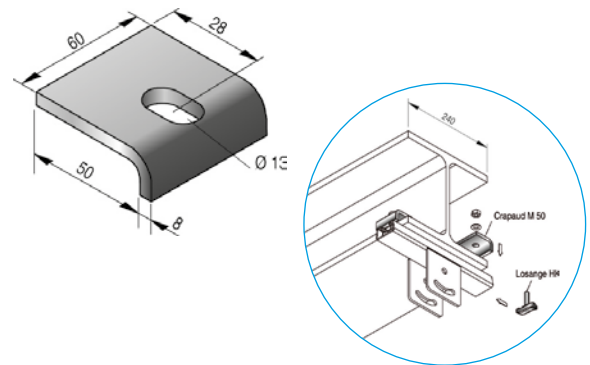

Recommended for heavy duty loads on metal beams with **STRUT 41** or **UPN channels**.

See table below for required nuts & bolts:

CLAMPING RANGE (MM)	PRODUCT USED FOR MOUNTING	CODE	CLAMPS	NUTS & BOLTS
 5>9 10>14 15>19 20>24 25>29 30>34 35>39	STRUT 41 	195800	 	Use: M10x30 bolts + H or M10 diamond nuts
		195909		
	196104 196203	UPN 40 U.5050* 	HSK.20 Clamp HSK.25 Clamp	
196005	HSK.30 Clamp HSK.35 Clamp HSK.40 Clamp			
196302 196401				
5>9 10>14 15>19 20>24 25>29 30>34 35>39	STRUT 41 	196425	 	Use: M12x35 bolts + H or M12 diamond nuts
		196432 196449		
20>24 25>29 30>34 35>39	UPN 40 U.5050* 	196456	 	Use: M12x50 bolts + H or M12 diamond nuts
196463				
196470				
196487				

* For U.5050 accessories use a HK T-head bolt

EARTHING SYSTEMS

EQUIPOTENTIAL BONDING AND GROUNDING

In France, metallic cable trays cannot be used as PE conductors. Please check local norms and regulations.

Therefore, the cable trays circuits must be connected to earth* in order to better equipotential bonding and make sure no electromagnetic disturbance will occur.

This can be done thanks to earthing bolts, clamps or earth strap.

*UTE C 15-900 36.7.2.4 : connect to earth every 15 metres or at each end if length is less than 15 metres

F-CLIP



p	Description	Code	Weight kg/p
AE 40	FCLIP 16-35	651314	0.019

- Equipotential bonding of mesh trays
- Quick assembly, no tools
- Suitable for use with all finishes

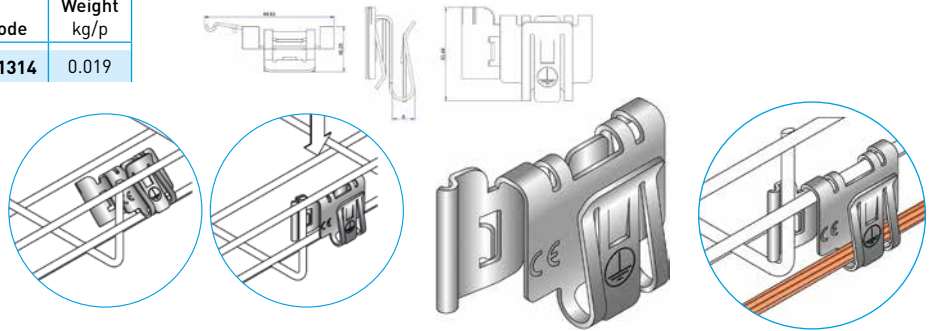

T-CLIP

p	Description	Code	Weight kg/p
AE 30	TCLIP 16-35	651313	0.017

- Equipotential bonding of cable trays
- Quick assembly, no tools nor bolts
- Also exists for mesh trays

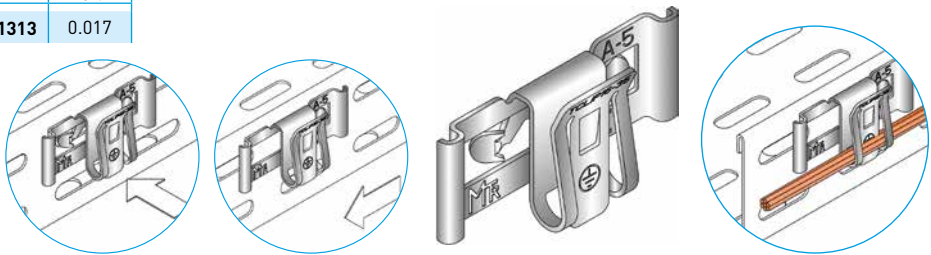

MT BOLTS

p	Description	Code	Weight kg/p
LT 20	EARTH BOLT 6-25 mm ²	651310	0.045
20	EARTH BOLT 6-35 mm ²	651309	0.072
20	EARTH BOLT 6-50 mm ²	651303	0.072
20	EARTH BOLT 6-95 mm ²	651300	0.080

Delivered with 2 Aluminium/Copper washers
+ 1 TRL M6x12 screw EZ

Suitable for use with all finishes

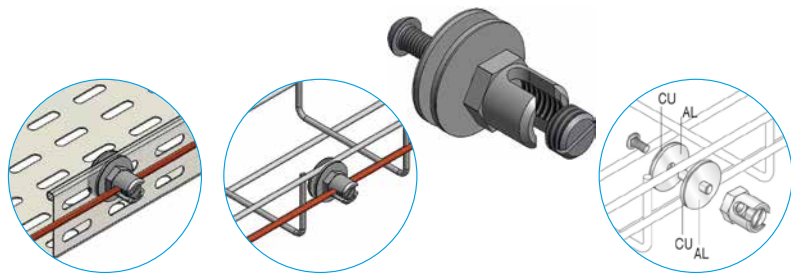

MT 10/50 CLAMP

p	Description	Code	Weight kg/p
LT 25	GMT 10/50	651311	0.040

Suitable for use with all finishes

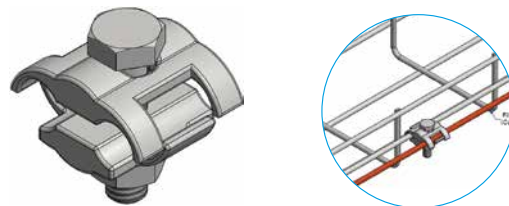

EARTH STRAP

p	Description	Code	Weight kg/p
LT 50	EARTH STRAP 16 mm ² L 100mm	651500	0.026

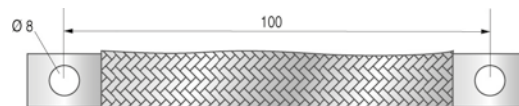

OTHER ACCESSORIES
STRUT PERFORATED STEEL BAND

	p	Description	Code	Weight kg/p	Th. mm	L mm	Ø mm
G	10	PERF.STEEL BAND 26x1.0 10M G	677384	1.540	1.00	26	8
	10	PERF.STEEL BAND 12x0.8 10M G	601326	0.540	1.00	12	5
	10	PERF.STEEL BAND 17x0.8 10M G	677383	0.730	1.00	17	7

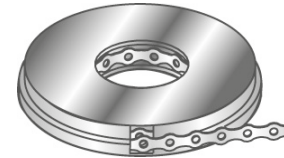

AEROSOL SPRAYS

	p	Description	Code	Weight kg/p
HDG	1	AEROSOL SPRAY	023550	0.550
EPO	1	IVORY 1 RAL 1013	085041	0.520
	1	YELLOW 7 RAL1003	085042	0.520
	1	ORANGE RAL 2009	085043	0.520
	1	RED 1 RAL 3020	085044	0.520
	1	BROWN RAL 8014	085045	0.520
	1	WHITE 4 RAL 9003	085046	0.520
	1	BLACK 19 RAL9005	085047	0.520
	1	GREY 1 RAL 7004	085048	0.520
	1	BLUE 24 RAL 5015	085049	0.520
	1	BLUE 49 RAL 5013	085050	0.520
	1	GREEN 49 RAL6024	085051	0.520
	1	GREEN 6005	085052	0.520

EDGE PROTECTION - ROLL

	p	Description	Code	Weight kg/p
PVC	10	EDGE PROT. GREY (10M)	040037	0.450
	10	EDGE PROT. 500 BLACK (20M)	030457	1.600

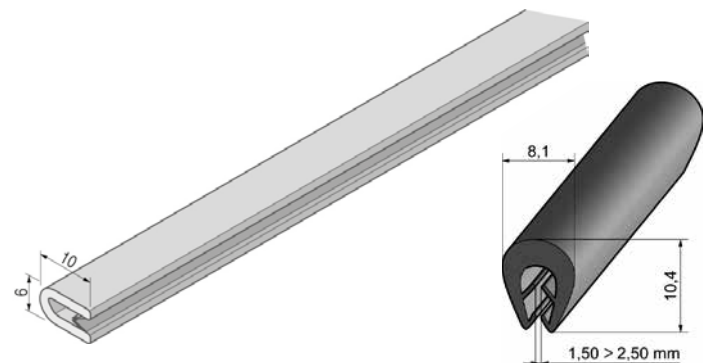
- Grey for **0.70 to 1.80 mm** thick cable trays, sold in **10 m rolls** (BS/PS types and equivalent)
- Black for **1.50 to 2.50 mm** thick cable trays sold in **20 m rolls** (BRP type and equivalent)

EDGE PROTECTION - METRE

	p	Description	Code	Weight kg/p
PVC	10	EDGE PROT. 500 BLACK (1M)	030481	0.080

For **1.50 to 2.50 mm** thick cable trays (BRP type and equivalent)

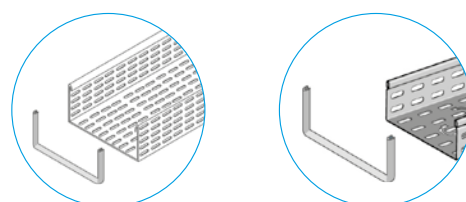

OTHER ACCESSORIES
CONCRETE SUPPORT

p	Description	Code	Weight kg/p
PVC	20 CONCRETE SUP PVC	088295	0.995

Roof terrace application for perforated and mesh cable tray

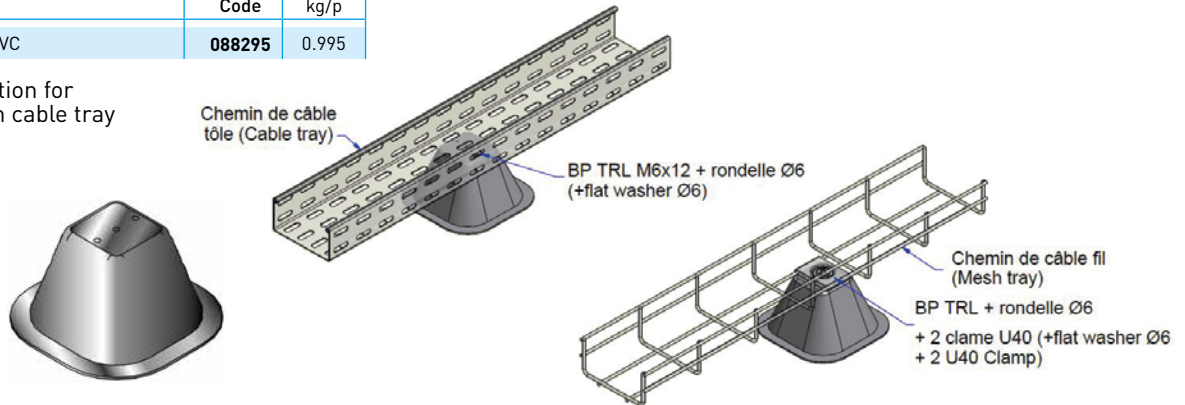

1712/1 AND 712/1 HOOKS

p	Description	Code	Weight	H1 mm	H2 mm	L1 mm	L2 mm
PP	50 1712/1 PP	700790	1.900	70	80	29	40
	50 712/1 PP	700792	1.800	70	80	29	40

- For 15 NYM 3x1.5 mm² cables max
- For wall and ceiling fixing
 - Use a 6mm diam. impact anchor for fixing
 - Recommended fixing distance: 0.5 - 0.6 m

Glow wire resistance :

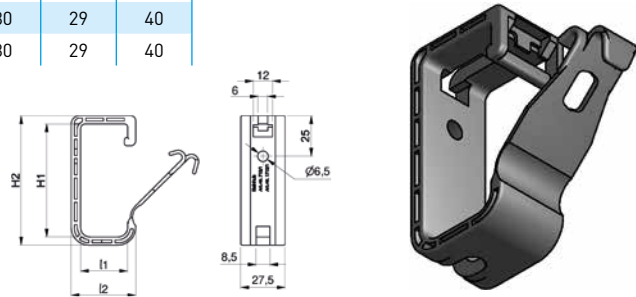
- 1712 → 750°C
- 712 → 960°C



1712/2 AND 712/2 HOOKS

p	Description	Code	Weight	H1 mm	H2 mm	L1 mm	L2 mm
PP	25 1712/2 PP	700788	3.500	105	120	45	60
	25 712/2 PP	700791	3.000	105	120	45	60

- For 30 NYM 3x1.5 mm² cables max
- For wall and ceiling fixing
 - Use a 6mm diam. impact anchor for fixing
 - Recommended fixing distance: 0.5 - 0.6 m

Glow wire resistance :

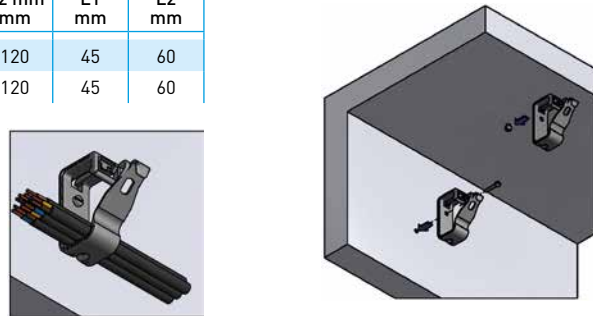
- 1712 → 750°C
- 712 → 960°C

CABLE CLASP

p	Description	Code	Weight
POM	25 794/100 POM	700764	0.700
	25 794/200 POM	700765	1.800

With 6mm diam. holes for fixing
White

- 794/100 : for max. 8-10 NYM 3x1.5 mm² cables
- 794/200 : for max. 16-20 NYM 3x1.5 mm² cables

